

LOG HOME *Fantasy* GIVEAWAY



A SUPPLEMENT TO

LOG HOMETM
DESIGN IDEAS

GRAND PRIZE

LOG HOME
PACKAGE

from Alta Log Homes



FIRST PRIZE

COMPLETE
BEDROOM FURNITURE
ENSEMBLE

from Scottsdale Art Factory

SECOND PRIZE

LOG BILLIARD
TABLE

from Roaring Fork Log Homes



WIN ONE OF THREE

GRAND PRIZE

LOG HOME PACKAGE

This Alta Log Homes Cape Chalet materials package is valued at over \$30,000! Its attractive design features three bedrooms including a loft bedroom, one bath and a covered porch with 1,288 total square feet of living area.



Since 1971

FIRST PRIZE

COMPLETE BEDROOM FURNITURE ENSEMBLE

This bedroom set from Scottsdale Art Factory is valued at \$15,000. It includes (1) 10" Mountain Lodge poster king bed with hand-carved cedar limb style headboard, (1) matching 9-drawer dresser, (1) matching tri-mirror with matching twig top design, (1) matching 6-drawer highboy and (2) matching 2-drawer nightstands.



SCOTTSDALE
Art
FACTORY

FABULOUS PRIZES!

LOG BILLIARD TABLE

This handcrafted billiard table from Roaring Fork Log Homes is valued at \$7,500. It is constructed of Englemann spruce with alder rails, Indian head nickels for aiming dots, horseshoes for pocket tops and a choice of cloth.

SECOND PRIZE



*Roaring Fork
Log Homes*

HOW TO ENTER:

It's easy to enter the Log Home Fantasy Giveaway. Look for the information card found inside the March 1999, May 1999, and July 1999 issues of *Log Home Design Ideas*. Circle Reader Response number **C-1** (along with the numbers of any companies from whom you would like to receive FREE information). Drop the card in the mail and you will be automatically entered in the sweepstakes! You may also enter by circling number **C-1** on the clip-out card found on page 120 of the May, 1999 issue and mailing it to the address listed on the card.

(See back page of this pamphlet for official rules.)

Actual prizes may vary slightly from representations shown; values at a given prize level will be approximately the same.

Please note that the items shown in paid advertisements of the participating companies are not necessarily the prizes being awarded in this sweepstakes.

Circle number **C-1**

LOG HOME DESIGN IDEAS
INFO CARD

NAME: _____
ADDRESS: _____
CITY: _____ STATE: _____ ZIP: _____
PHONE: _____

SEND INFORMATION TO:

1	2	3	4	5	6	7	8	9	10	11	12	13	14	15	16	17	18	19	20	21	22	23	24	25	26	27	28	29	30	31	32	33	34	35	36	37	38	39	40	41	42	43	44	45	46	47	48	49	50	51	52	53	54	55	56	57	58	59	60	61	62	63	64	65	66	67	68	69	70	71	72	73	74	75	76	77	78	79	80	81	82	83	84	85	86	87	88	89	90	91	92	93	94	95	96	97	98	99	00
---	---	---	---	---	---	---	---	---	----	----	----	----	----	----	----	----	----	----	----	----	----	----	----	----	----	----	----	----	----	----	----	----	----	----	----	----	----	----	----	----	----	----	----	----	----	----	----	----	----	----	----	----	----	----	----	----	----	----	----	----	----	----	----	----	----	----	----	----	----	----	----	----	----	----	----	----	----	----	----	----	----	----	----	----	----	----	----	----	----	----	----	----	----	----	----	----	----	----	----

Circle number **C-1**

**GRAND
PRIZE
PARTICIPANT**

the

Artistry

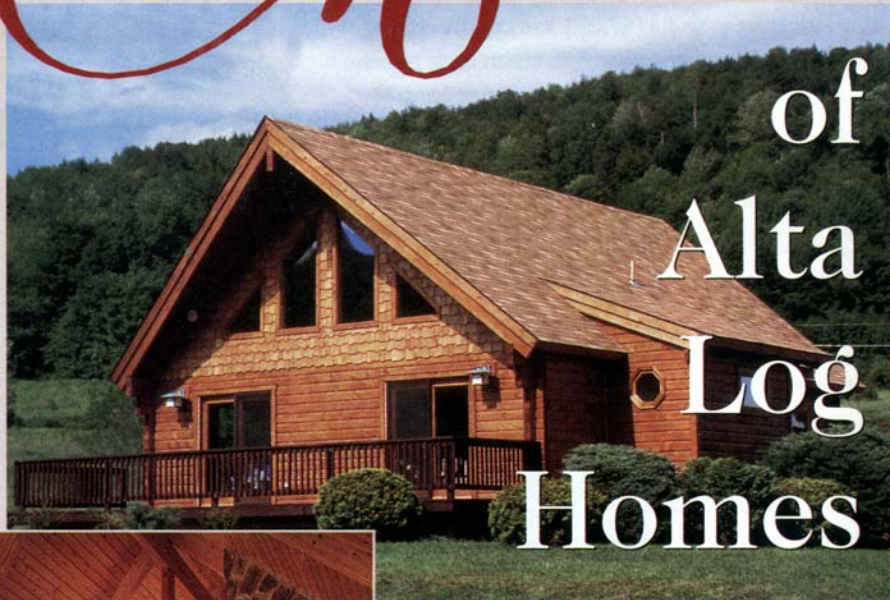

of
Alta
Log
Homes



*28 Years of
World Class
Quality*

Alta Log Homes

P.O. Box 88, Dept. LHDI-29

Halcottsville, NY 12438

1-800-926-2582

www.altahome.com



Since 1971

Order your Alta Plan Book



for only \$5.00



Alta Log Homes ...



“Make a statement”



Alta Log Homes offers a lifestyle choice. It's the choice that numerous homeowners throughout the nation have made over the past 28 years. It's a choice we know is right for you and your family. Make a statement with Alta.



You could WIN this home!

Alta Cape Chalet

GRAND PRIZE

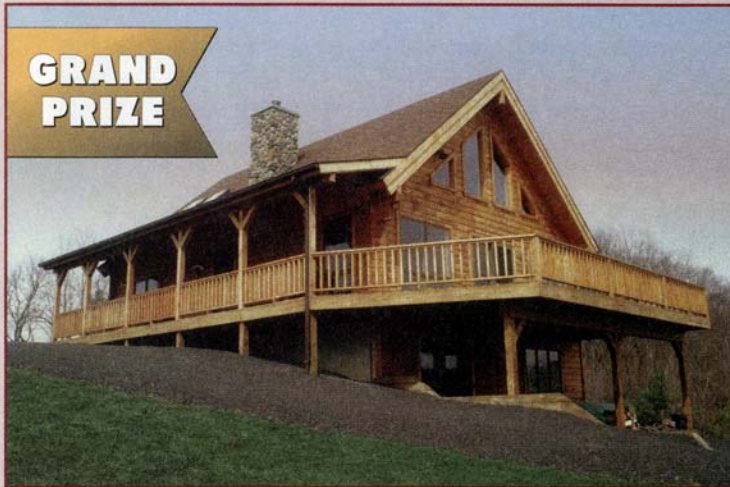

Living Area:

38' x 24'
912 sq. ft.
first floor
376 sq. ft.
loft

Features:

3 Bedrooms
1 Bath
Covered Porch

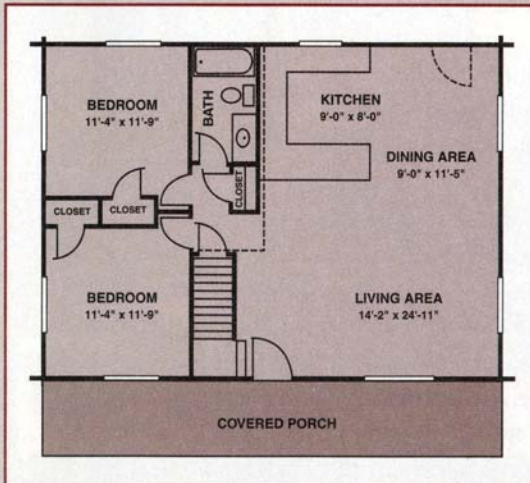

Retail Value:
\$30,600

Materials Package

Please note: photo above shows optional upgrades not included in standard package; i.e. decks, fireplace, traps, etc.

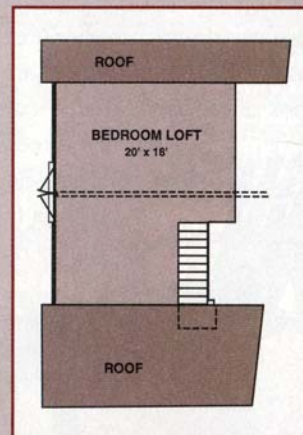

Alta's Cape Chalet series provides an attractive blend of two favorite traditional styles. A full-length covered porch with decorative posts adds to this home's attractiveness.

Alta Log Homes, P.O. Box 88, Dept. LHDI-29
Halcottsville, NY 12438 • 1-800-926-ALTA

Circle Reader Response #3

**FIRST
PRIZE**
PARTICIPANT

**Enter the Log Home Fantasy Sweepstakes.
You could win the bedroom furniture set
pictured below – a \$15,000 value
from Scottsdale Art Factory!**



Since 1913 Scottsdale Art Factory L.L.C. has been building custom designed furniture to your specifications. We believe in making products the "old fashioned way" and with Mother Nature's best materials. The design department, led by internationally accredited artist **H.J. Nick**, has professional designers aided by state-of-the-art computers and other equipment. Scottsdale Art Factory approaches its world class product line by beginning with fine signature art from commissioned prestigious and seasoned artists, as well as ideas derived from you, the consumer, and other sources. We are then able to offer our customers a wide selection of original art pieces as well as limited editions, or reproductions of the original art. Scottsdale Art Factory purchases huge quantities of raw material direct, and this purchasing power combined with our large national sales volume allows us to offer you the best hand-crafted furniture and decorative accessories you can purchase made exactly the way you want, complete with



*Adirondack style lounge by
Scottsdale Art Factory (not
included with bedroom set prize).*

our Price Guarantee to beat any comparable manufacturer's price! Some of the materials used include exotic cedar, copper, iron and other natural metals, stone, leather and tile. There is no extra cost for custom orders, and **SATISFACTION IS GUARANTEED.**

Designs By

H. J. Nick



Designer Furnishings
at Ordinary Prices



Custom Valances
Any Style

For An Exclusive
Scottsdale Art
Factory Gallery
Near You Call

Free Full Color Factory Direct Catalog

Offering Over 5000 Award Winning Designs In Ten Distinctive Styles
All Items Guaranteed "Forever" (no questions asked)
Backed By Over Eight Decades Of Fine Craftsmanship



602-244-2828



All Items
Handmade
In The U.S.A.

1-800-292-0008 Redeemable Deposit Required

DEALERS INVITED

<http://scottsdale.artfactory.com>

Circle Reader Response #121

**SECOND
PRIZE
PARTICIPANT**

Roaring Fork Log Furniture is very unique...

The design of each piece of furniture is determined by the natural colors, textures, shapes and sizes of the various types of woods used.

Each piece is made by hand, utilizing true craftsmanship to fit one piece of wood to another.



***We put a bit of this in every
billiard table we build.***



Some of the types of wood used include spruce, aspen, scrub oak, juniper, mesquite, lodgepole burls, walnut, ash and red & white oak.

Enter the Fantasy Log Home Giveaway today ... you just may win one of our custom-designed billiard tables valued at \$7,500.

Roaring Fork Log Homes

• ***Handcrafted Log & Timber Billiard Tables***
670 Redstone Avenue, Carbondale, Colorado 81623
shop (970) 928-0659 home (970) 963-0451

Circle Reader Response #278

*Plan
on this!*

Available beginning
March 13, 1999
at your local
newsstand.

FLOOR PLANS



Don't miss FLOOR PLANS 2000, our annual issue featuring dozens of fabulous log home floor plans. With over 100 plans listed by company in an informative, easy-to-read format, FLOOR PLANS 2000 is your key to exploring the best offerings of the exciting log home industry.

LOG HOME™ DESIGN IDEAS

Pictured above: cover of FLOOR PLANS 1999

LOG HOME *Fantasy* GIVEAWAY

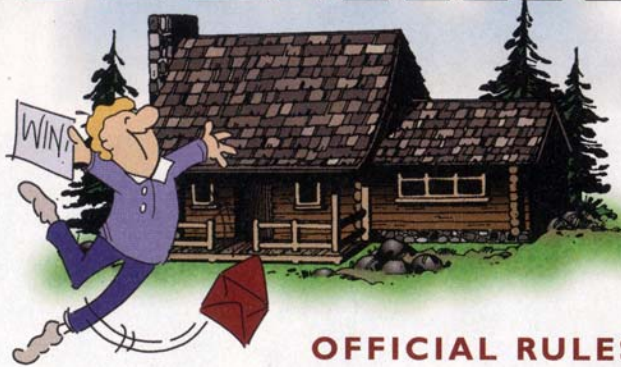

OFFICIAL RULES

NO PURCHASE NECESSARY. VOID WHERE PROHIBITED.

1. To Enter To be entered automatically into the sweepstakes, circle number C-1 on the reader response card (along with any other numbers of companies from which you would like free information) which can be found in the March 1999, May 1999 and July 1999 issues of Log Home Design Ideas and mail it to the address printed on the card. If you do not have a response card or you do not wish to be entered automatically, you may request a copy of the official rules or enter by mailing a postcard with your name, address and day & nighttime phone numbers to: LHDI Sweepstakes, 1620 South Lawe Street, Suite #2, Appleton, WI 54915. All entries must be postmarked between January 1, 1999 and July 15, 1999 and received by July 22, 1999. Limit one entry per household or address per issue.

2. Eligibility Open to legal residents of the United States (excluding Puerto Rico) only, who are 18 years of age or older as of January 1, 1999. Employees of the sponsor H&S Media, Inc., AthEnet Data/Exchange and their respective agents, those domiciled with such employees and members of their immediate families are not eligible.

3. Drawing Selected entrants will be determined in a random drawing from all eligible entries received on or about August 1, 1999, by AthEnet Data/Exchange, an independent judge, whose decisions are final on all matters related to the sweepstakes. Selected entrants will be notified by certified mail and announced on September 9, 1999 in the November, 1999 issue and the Log Home Design Ideas web site (www.lhdi.com). All prizes will be awarded. If a selected entrant cannot be contacted and confirmed as a winner within twenty-one (21) days, an alternate entrant will be selected. No cash equivalents, prize substitutions or transfer of prizes permitted, except at the sole discretion of the sponsor. The odds of winning depend on the number of eligible entries received.

4. Prizes: One (1) Grand Prize: A log home package from Alta Log Homes. Approximate retail value: \$30,600 (U.S.). **One (1) First Prize:** A complete bedroom furniture ensemble from Scottsdale Art Factory. Approximate retail value: \$15,000 (U.S.). **One (1) Second Prize:** A log pool table from Roaring Fork Log Homes. Approximate retail value: \$7,500 (U.S.). Construction costs of the home, shipping costs of the prizes, taxes and all other expenses not specifically mentioned are the sole responsibility of the winner. Selected entrants will be required to sign an affidavit of eligibility and release of publicity/liability to be received within fourteen (14) days of the notification of winning or prize will be forfeited and an alternate winner will be selected.

5. General By participating in this sweepstakes, you agree: (a) to be bound by these rules; (b) to release and hold harmless the sponsor and other parties from any liability for damages arising out of the acceptance, use, misuse, or possession of any prize received in this sweepstakes; (c) to the use, without additional compensation, of your name/likeness for advertising for publicity purposes, except where prohibited by law; and (d) to bear sole responsibility for any taxes resulting from the acceptance of your prize. Entries that are mutilated, altered, forged or obtained through unauthorized sources will be judged void. The sponsor reserves the right to substitute a prize of comparable value, whether in cash or otherwise, if a prize cannot be awarded as described for any reason. This sweepstakes is subject to all applicable federal, state and local laws and regulations.

6. Winners' List To obtain a list of winners, send a self-addressed stamped envelope to be received by September 9, 1999 to: LHDI Sweepstakes Winners' List, 2121 Waukegan Road, Suite #120, Bannockburn, IL 60015. ©1998, H&S Media, Inc.

SUPPLEMENT TO LOG HOME DESIGN IDEAS